

# Millbrook Huguenot Riverside Park Development Project Update

## ► Project information

Summer 2011 is set to be an exciting time for your local area of Millbrook and Huguenot. Development of a new riverside park, made possible by funding from the Heritage Lottery Fund and Lisburn City Council, will be managed by the Laganscape Project based in Lagan Valley Regional Park and the Council. The project will see the creation of a new recreation amenity for visitors including an adventure playground, multi-use games area, improved footpaths, and installation of fishing stands along the River Lagan.

Two new entrances will be created at Millbrook and Huguenot and interpretive panels erected to help tell the story of this interesting site. Not forgetting the heritage of the area, the project will see the restoration of the old factory walls and footbridge which was used by many of the local residents on their way to the old Hilden Mill. Overall, the project will involve improvements to the environment creating a pleasant and enjoyable site for local residents and visitors alike.

## ► Start and finish dates and access

Work is due to begin on site early June by local contractors and is due for completion this autumn. The first phase will include construction of the adventure playground and an upgrade of paths beside the blue bridge downstream of the Island Civic Centre. Access to and from the blue bridge will remain open, however, during the construction phase there will be closure of footpaths through the site from the Island Centre to Huguenot Drive. We apologise for any inconvenience caused and appreciate your patience at this time. Further updates will be provided as work progresses.

As part of the project the Laganscape team hope to work with local communities to help gather stories of the history of the area, if you have any information please contact Laganscape Manager, Cathy Burns. The team will also involve local schools and community volunteers in the creation of wild flower areas, and species protection.



## For More Information:

**Suzanne Lutton**  
Lagan Corridor Regeneration Manager  
Lisburn City Council  
Tel: 028 9250 9485  
Email: [suzanne.lutton@lisburn.gov.uk](mailto:suzanne.lutton@lisburn.gov.uk)  
Web: [lisburncity.gov.uk](http://lisburncity.gov.uk)

**Cathy Burns**  
Laganscape Manager  
Lagan Valley Regional Park  
Tel: 028 9049 1922  
Email: [cathy@laganvalley.co.uk](mailto:cathy@laganvalley.co.uk)  
Web: [laganvalley.co.uk](http://laganvalley.co.uk)

**Map showing riverside improvements**

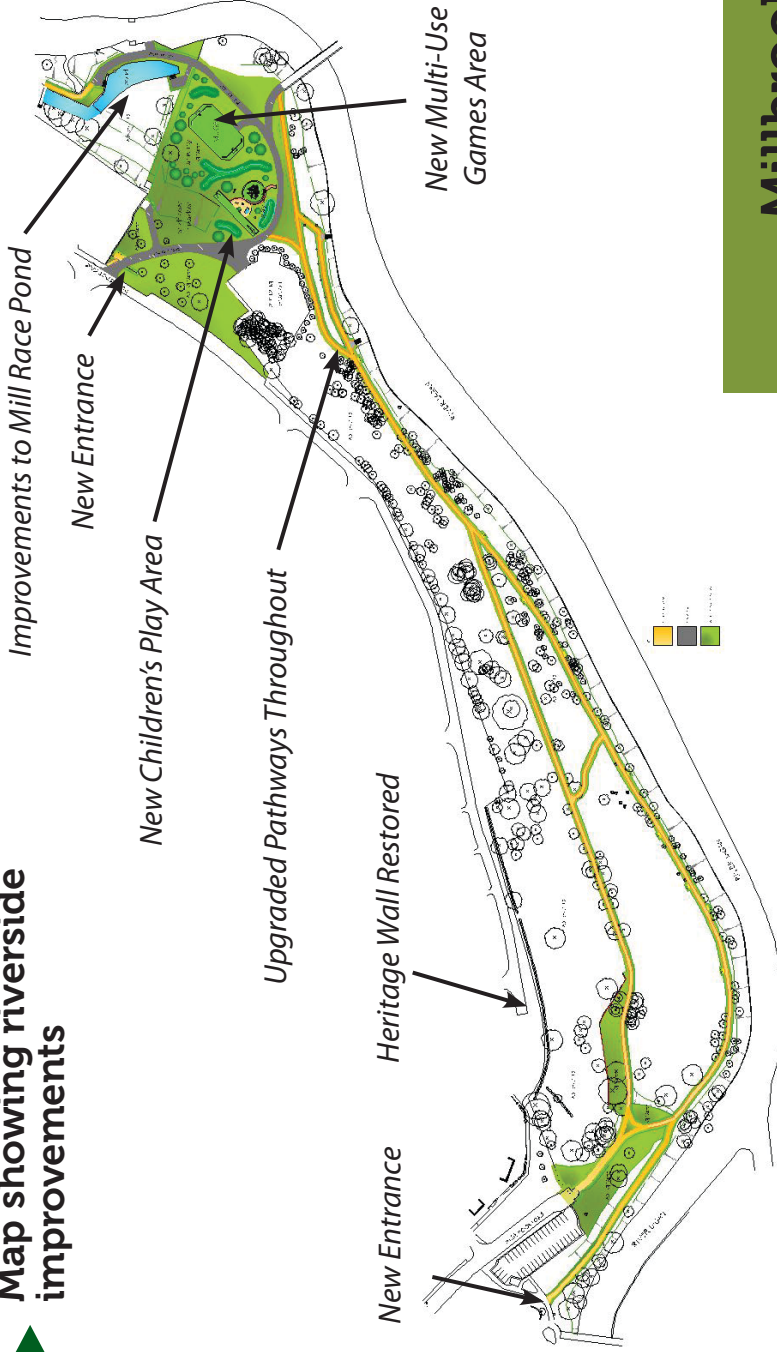

**Millbrook  
Huguenot  
Riverside Park**



Supported by  
**The National Lottery**  
through the Heritage Lottery Fund

